

BIRNS, INC.
 FACTORY INFORMATION
 FOR CUSTOMER USE ONLY. THIS INFORMATION IS NOT TO BE REPRODUCED OR TRANSMITTED IN ANY FORM OR BY ANY MEANS, ELECTRONIC OR MECHANICAL, INCLUDING PHOTOCOPYING, RECORDING, OR BY ANY INFORMATION STORAGE AND RETRIEVAL SYSTEM. ALL RIGHTS RESERVED. © 2015 BIRNS, INC.

REVISIONS				
ZONE	REV	DESCRIPTION	DATE	APPROVED

NOTES: UNLESS OTHERWISE SPECIFIED.

- 1. SEE TABLE 1 FOR LAMP OPTIONS.
- 2. SOME HIDDEN LINES OMITTED FOR CLARITY.

TABLE 1, LAMP OPTIONS

PART NO.	VOLT/WATT
32B-002	120V/100W
32B-003	120V/150W
32B-004	120V/250W
32B-005	120V/500W
32B-016	240V/100W
32B-015	240V/150W
32B-017	240V/250W
32B-018	240V/500W

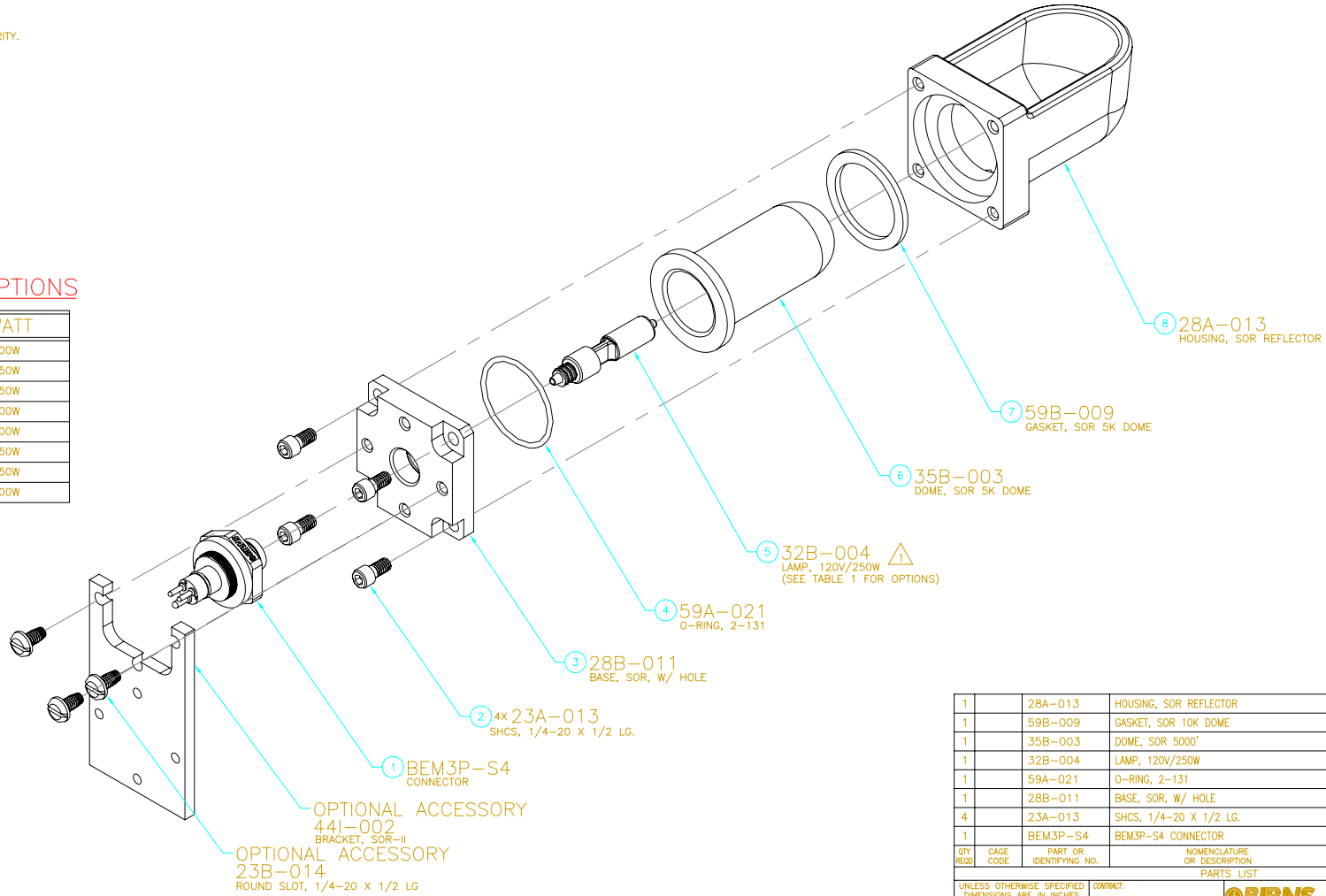

QTY REQD	CAGE CODE	PART OR IDENTIFYING NO.	NOMENCLATURE OR DESCRIPTION	MATERIAL SPECIFICATION	ZONE	ITEM NO
1		28A-013	HOUSING, SOR REFLECTOR	6061-T6 ALUMINUM		8
1		59B-009	GASKET, SOR 10K DOME	SILICONE		7
1		35B-003	DOME, SOR 5000'	BOROSILICATE		6
1		32B-004	LAMP, 120V/250W	QUARTZ		5
1		59A-021	O-RING, 2-131	BUNA 70		4
1		28B-011	BASE, SOR, W/ HOLE	6061-T6 ALUMINUM		3
4		23A-013	SHCS, 1/4-20 X 1/2 LG.	18-8 S.S.		2
1		BEM3P-S4	BEM3P-S4 CONNECTOR	GRE		1

UNLESS OTHERWISE SPECIFIED DIMENSIONS ARE IN INCHES AND PER ASME Y14.5-1994 TOLERANCES ARE: .XX ± .01 .XXX ± .005 .XXXX ± .0005 ∠ ± .5

CONTRACT: DWG K. WOOD 050725 TITLE SOR, 5000' EXPLODED VIEW

DESIGN ENGR CA J. MAGLAQUE 050725 SIZE D 58608 DWG NO. 5131-01-20 REV

APRD E. BIRNS 050812 SCALE: 1/1 UNIT WT.: 1.9 LBS SHEET 1 OF 1

APPLICATION DO NOT SCALE DRAWING

