

40-500-005-00



**MILLENNIUM  
SERIES**

**3P-RIP**

TABLE 1: AVAILABLE INSERTS

| PART NO.  | CONTACT SIZES       |
|-----------|---------------------|
| 3P-RIP-13 | 13, #10             |
| 3P-RIP-17 | 17, #14             |
| 3P-RIP-25 | 25 #16              |
| 3P-RIP-40 | 40 #20              |
| 3P-RIP-C  | 50 OHM COAX         |
| 3P-RIP-C6 | 75 OHM COAX; 6, #22 |

**3P-RIP-C**

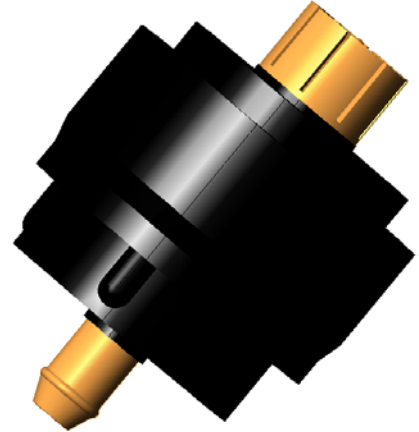

ISOMETRIC VIEW SHOWN ASSEMBLED FOR REFERENCE ONLY

**3P-RIP**

(#16AWG MODIFIED PIN)

( $\phi 1.140$ )

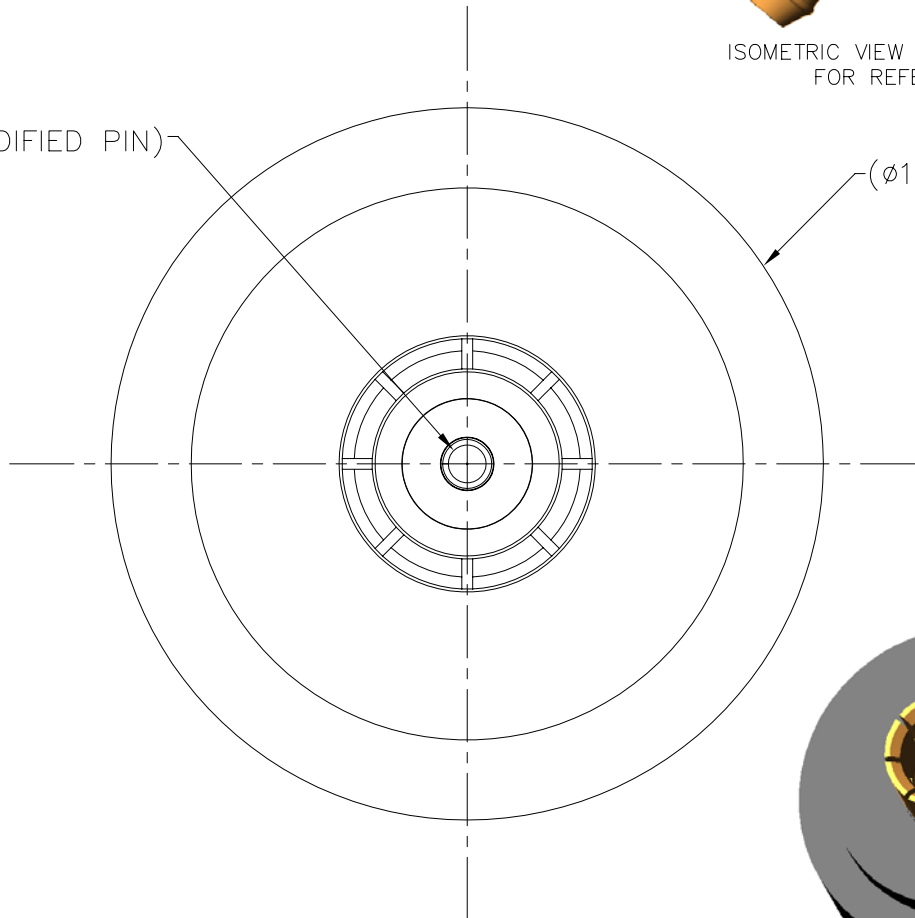

FACE VIEWS

PIN CONFIGURATION

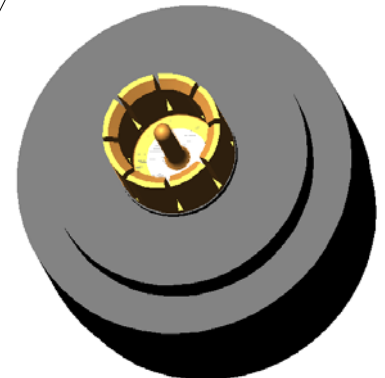

ISOMETRIC VIEW SHOWN ASSEMBLED FOR REFERENCE ONLY

1720 Fiske Place Oxnard, California 93033-1863  
 Phone: (805) 487-5393 FAX: (805) 487-0427 Email: [service@birns.com](mailto:service@birns.com)  
[www.birns.com](http://www.birns.com)

USA Toll-Free:  
 888-BIRNS-88